

University of Hertfordshire **UH** Hertfordshire
International College

INTERNATIONAL
STUDENT GUIDE 2020/2021

THREE GREAT REASONS TO STUDY WITH US



STUDY JUST **25**
MINUTES **FROM** CENTRAL
LONDON BY **TRAIN**

96.5% OF **GRADUATES**
ARE IN **WORK** OR **FURTHER**
STUDY WITHIN **6** MONTHS



2ND SAFEST UNIVERSITY
TOWN IN THE **EAST**
OF **ENGLAND**

(THE COMPLETE UNIVERSITY GUIDE – CRIME STATISTICS – ENGLAND & WALES, 2020)

TEACHING EXCELLENCE

INTERNATIONALLY ACCLAIMED TEACHING EXCELLENCE

Our country's education system is highly respected all over the world, and a strong British degree really is a passport to a rewarding career, wherever you want to live and work.

British higher education qualifications are rigorous and intellectually challenging. They have to be because we're continuously assessed to make sure we give you the exceptional education you deserve. We know that coming to university – especially one overseas – is a major investment of time and money, so we make sure you graduate with the best possible knowledge, experience, skills and career prospects. Our lecturers have a wealth of experience in their field; not just in an academic setting, but also out in the working world – whether that's in business, law, healthcare, sciences, engineering or the creative industries. They've built businesses, developed technologies, saved lives, pushed boundaries and made a real difference. Now they're here to help you do the same.

In 2018, we were awarded the top accolade of Gold in the Teaching Excellence Framework (TEF), a government ranking of how well students are taught at British universities. The prestigious Times Higher Education (THE) and QS World Rankings also rank us as one of the Top 150 Universities under 50 Years Old in the world.

We were also announced as one of 17 finalists in the world for the prestigious Global Teaching Excellence Award 2018.

There's also good news if you're looking for postgraduate research opportunities. Our strong reputation for research means you'll have the chance to work with innovative, leading thinkers who are exploring world-changing new ideas. Over 90% of our research has been judged to be of international quality. It's changing the way people think, work and live across the world. All of that acclaimed research informs our teaching and gives you access to the latest concepts and developments in your subject.



Teaching
Excellence
Framework

ACADEMIC SERVICES

The Academic Services Support Team provides support to students in all aspects of the student's life. Our aim is to ensure students have the best possible experience and to support them throughout their journey.

The best part in my role as Academic Services Manager is seeing students achieve their potential and progress on to their next level of study.

We will support you with all aspects in your academic journey, such as timetabling, support with your learning and exams to ensure you progress throughout your course.

KAROLINE GILES

Acting Head of College Services

STUDENT SERVICES

Our Student Service Support contributes to the student's journey by communicating with them once they have been successful on their Visa application until they progress to the University of Hertfordshire. As a working family we help students in many aspects and will refer students to specialist support to ensure you progress on your course.

The best part in my role as a Student Service Manager is building relationships with the student and seeing them succeed, therefore helping them to enjoy their student journey.

We are responsible for the orientation of new students as well as overseeing the student's welfare, accommodation, finance, attendance and extracurricular activities.

CLAIRE BUTCHER

Manager of Student Services



WELCOME TO A BIGGER, BRIGHTER FUTURE



Over the past 15 years, 6,000 students have studied at HIC and have gone on to graduate with a degree from the University of Hertfordshire.

HIC is a very proud partner of the University, and through the continued success of our students we are pleased to develop and expand our long-standing relationship. We share a vision and commitment to academic excellence and student experience for meeting the higher education needs of international students and the regions they live in.

The pathway programmes provide students with unique educational experience that help you to build your future and sail you away to a land of opportunity to succeed.

I, on behalf of the College, offer you the warmest of welcomes and very best wishes for your future studies with us.

DR SARAH LIU

HIC College Director & Principal

SUPPORTING YOU ALL THE WAY

At HIC, you never have to deal with your problems alone. We have a friendly team dedicated to giving you the help you need, from financial advice to confidential counselling.

HIC STUDENT SERVICES

HIC provides many support services that will help you achieve your goals. During your studies you will have access to services offered by both HIC and the University of Hertfordshire. We encourage you to use the support services available and to contact the HIC staff for advice and assistance as soon as you are having difficulty with anything. Remember that HIC is here to help you.

The Student Support team looks after all of our students' needs. The team is responsible for:

- helping you enrol in your pathway
- assisting with your registration at HIC and the University of Hertfordshire
- orientation programmes
- student welfare
- study skills training
- learning support
- English language support
- disability support
- assignment assistance
- social activities.

UNIVERSITY OF HERTFORDSHIRE HUTTON HUB

In 2015, we opened our new Hutton Hub building at the heart of the College Lane Campus, right next door to the Forum. It's a one-stop-shop for all of our student support services, so if you're ever unsure who to ask for advice, just pop in. It's home to:

- Student Centre
- Careers, Employment and Enterprise
- Study Abroad Office
- Campus Pharmacy
- University Medical Centre
- Student Wellbeing
- Occupational Health
- Student Support
- Students' Union
- Santander Bank

There's also the Hutton Lounge, where you can relax, meet friends or study as a group. The building's open daily from 7.00am to 10.00pm and you can find opening hours for each support team at: ask@herts.ac.uk

THE STUDENT CENTRE

Our Student Centre team is on hand to make sure your time at university runs as smoothly as possible. They can advise you on a whole range of issues, including applying for courses, finance, funding, accommodation, council tax and renewing your visa.

THE UNIVERSITY MEDICAL CENTRE

As well as help when you're feeling unwell, our modern GP practice offers expert, confidential advice on any health worries. Don't forget to register when you start university.

CHAPLAINCY AND RELIGION

Based at the Key, our multi-faith, multi-cultural centre, our University Chaplain leads a team supporting the whole University community. We also have student-led societies based on a whole range of faiths. Find out more at: go.herts.ac.uk/chaplaincy

STUDENT WELLBEING

The Student Wellbeing team offers free, professional, confidential counselling and mental health advice, as well as workshops and self-help resources. If you have a disability, they can help you access tailored support to help with your studies.



UNDERGRADUATE COURSES

ANIMATION & GAMING

BA (Hons) 2D Animation and Character for Digital Media
BA (Hons) 3D Computer Animation and Modelling
BA (Hons) 3D Games Art & Design

ART & DESIGN

BA (Hons) Architecture
BA (Hons) Design Crafts
BA (Hons) Design Crafts (Ceramics and Glass)
BA (Hons) Design Crafts (Jewellery)
BA (Hons) Design Crafts (Textiles)
BA (Hons) Digital Media Design
BA (Hons) Fine Art
BA (Hons) Graphic Design
BA (Hons) Graphic Design: Advertising and Branding.
BA (Hons) Illustration
BA (Hons) Interior Architecture and Design
BA (Hons) Model Design (Character and Creative Effects)
BA (Hons) Model Design (Model Effects)
BA (Hons) Model Design (Special Effects)
BA (Hons) Photography
BA (Hons) Product and Industrial Design

BUSINESS & MANAGEMENT

BA (Hons) Accounting
BA (Hons) Accounting and Finance
BA (Hons) Business Administration
BA (Hons) Business Economics
BA (Hons) Economics
BA (Hons) Event Management
BA (Hons) Finance
BA (Hons) Marketing
BA (Hons) Music Industry Management

COMPUTER SCIENCE

BSc (Hons) Computer Science
BSc (Hons) Computer Science (Artificial Intelligence)
BSc (Hons) Computer Science (Networks)
BSc (Hons) Computer Science (Software Engineering)
BSc (Hons) Information Technology

EDUCATION

BA (Hons) Early Childhood Education
BA (Hons) Education Studies

ENGINEERING & TECHNOLOGY

BEng (Hons) Aerospace Engineering
BEng (Hons) Aerospace Engineering with Space Technology
BEng (Hons) Aerospace Systems Engineering
BEng (Hons) Aerospace Systems Engineering with Pilot Studies
BEng (Hons) Automotive Engineering
BEng (Hons) Automotive Engineering with Motorsport
BEng (Hons) Civil Engineering
BEng (Hons) Electrical and Electronic Engineering
BEng (Hons) Electronic Engineering and Mechatronics
BEng (Hons) Mechanical Engineering
BEng (Hons) Mechanical Engineering with Mechatronics
BSc (Hons) Aerospace Technology with Management
BSc (Hons) Aerospace Technology with Pilot Studies
BSc (Hons) Automotive Technology with Management
BSc (Hons) Computer Technology and Networks
BSc (Hons) Motorsport Technology

FASHION

BA (Hons) Fashion and Fashion Business
BA (Hons) Fashion Design

FILM, TV & MUSIC PRODUCTION

BA (Hons) Film and Television Production
BA (Hons) Visual Effects for Film and Television
BSc (Hons) Audio Recording and Production
BSc (Hons) Live Sound & Lighting Technology
BSc (Hons) Music Composition and Technology
BSc (Hons) Music Composition and Technology for Film and Games
BSc (Hons) Music and Sound Design Technology
BSc (Hons) Music Production
BSc (Hons) Music Technology
BSc (Hons) Songwriting and Music Production
BSc (Hons) Sound Design Technology

HEALTH CARE

BSc (Hons) Nursing (Adult)
BSc (Hons) Nursing (Child)
BSc (Hons) Nursing (Mental Health)
BSc (Hons) Nursing (Learning Disabilities)
BSc (Hons) Midwifery
BSc (Hons) Physiotherapy
BSc (Hons) Diagnostic Radiography and Imaging
BSc (Hons) Radiotherapy and Oncology
BSc (Hons) Paramedic Science

LAW

LLB (Hons) Criminal Justice and Criminology
LLB (Hons) Law

LIFE & MEDICAL SCIENCES

BSc (Hons) Applied Plant and Animal Biology
BSc (Hons) Biochemistry
BSc (Hons) Biological Sciences
BSc (Hons) Biomedical Science
BSc (Hons) Environmental Management and Ecology
BSc (Hons) Geography
BSc (Hons) Human Geography
BSc (Hons) Molecular Biology
BSc (Hons) Nutrition
BSc (Hons) Pharmaceutical Science
BSc (Hons) Pharmacology
BSc (Hons) Physical Geography
BSc (Hons) Psychology
BSc (Hons) Sport and Exercise Science
BSc (Hons) Sports Studies

MEDIA & JOURNALISM

BA (Hons) Journalism and Media
BA (Hons) Mass Communications
BA (Hons) Media

PHYSICS, ASTRONOMY & MATHEMATICS

BSc (Hons) Astrophysics
BSc (Hons) Financial Mathematics
BSc (Hons) Mathematics
BSc (Hons) Physics

TOURISM

BA (Hons) Tourism Management

POSTGRADUATE COURSES

ANIMATION & GAMING

MA Animation
MA Games Art and Design

ART & DESIGN

MA Art Therapy (two year programme)
MA Contemporary Crafts
MA Contemporary Textiles
MA Digital Media Arts
MA Fine Art
MA Graphic Design
MA Illustration
MA Interior Architecture and Design
MA Photography
MA Product Design

BUSINESS & MANAGEMENT

MA Human Resource Management
MSc Finance and Investment Banking
MSc Finance and Investment Banking with Work Placement
MSc International Business
MSc International Business with Work Placement
MSc Management
MSc Marketing
MSc Project Management

EDUCATION

MA Education
MA Early Childhood Education
MA Educational Leadership
MA International Education

FASHION

MA Fashion

FILM, TV & MUSIC PRODUCTION

MA Creative Music Production
MA Film and Television
MSc Music and Sound for Film and Games
MSc Music and Sound Technology (Audio Engineering)
MSc Music and Sound Technology (Programming)

TOURISM

MSc International Tourism, Hospitality and Events Management
MSc International Tourism, Hospitality and Events Management with Work Placement

ENGLISH LANGUAGE COURSES

Study on a Joint CAS with UKVI IELTS 5.5

Join 34 Weeks English with just IELTS 3.5

HIC offers Intensive English Language (IEL) courses specifically for students who need to improve their English language skills before entering their undergraduate or postgraduate pathway. English courses are held every semester and are all available to start in September, January or May.

By undertaking an IEL course at HIC you will:

- develop a broad, academically useful vocabulary
- improve your pronunciation and grammatical skills
- build skills to improve your lecture note taking and seminar participation
- develop your writing skills for essays, reports and academic assignments
- improve your reading comprehension
- develop research skills needed to read academic texts, journals and papers efficiently and effectively

IEL A

6 weeks (25 hours per week) IELTS score of 5.0 with no less than 5.0 in any band if you are progressing to stage 1 or IELTS score of 5.5 with no less than 5.0 in any band if you are progressing straight to stage 2.

IEL B

12 weeks (20 hours per week) IELTS score of 4.5 with no band less than 4.5 in any band.

IEL C

22 weeks (20 hours per week) IELTS score of 4.0 with no band less than 4.0 in any band.

IEL D

34 weeks (20 hours per week) IELTS score of 3.5 with no band less than 3.0 in any band.

Students who take UKVI IELTS and qualify for IEL A or IEL B may be eligible for a joint CAS at either NQF6 or NQF7 and will be given a joint offer by our admissions team.

TUITION FEES

ENGLISH

Course	EU and International fees for 2020/2021
IEL A – 6 Weeks	£3,850
IEL B – 12 Weeks	£7,500
IEL C – 22 Weeks	£10,750
IEL D – 34 Weeks	£13,950

UNDERGRADUATE

Course	Student fees 2020/2021	
	International	EU
Foundation (2 semesters)	£13,100	£9,250
Foundation (1 semester)	£9,000	£9,250
First Year (classroom-based)	£13,900	£9,250
First Year (lab-based)	£13,900	£9,250
Second & Final Years (classroom-based)*	£13,000	£9,250
Second & Final Years (lab-based)*	£13,000	£9,250

POSTGRADUATE

Course	Student fees 2020/2021	
	International	EU
Pre-Master's (3 semesters)	£16,950	£9,710
Pre-Master's (2 semesters)	£12,750	£8,440
Pre-Master's (1 semester)	£9,350	£7,110
Master's*	£13,500	£8,400

* This fee is paid directly to the University of Hertfordshire.

LAB-BASED PATHWAYS:

- Animation & Gaming
- Art & Design
- Computer Science
- Engineering & Technology
- Fashion
- Film, TV & Music Production
- Life & Medical Sciences
- Physics, Astronomy & Mathematics

CLASSROOM-BASED PATHWAYS:

- Business & Management
- Law
- Media & Journalism
- Tourism
- Education

All course fees may be subject to review.

For the most up to date HIC fee listings, visit hic.navitas.com/fees.

For the most up to date University of Hertfordshire fee listings, visit herts.ac.uk/courses/fees-and-funding and follow the link to "international students".

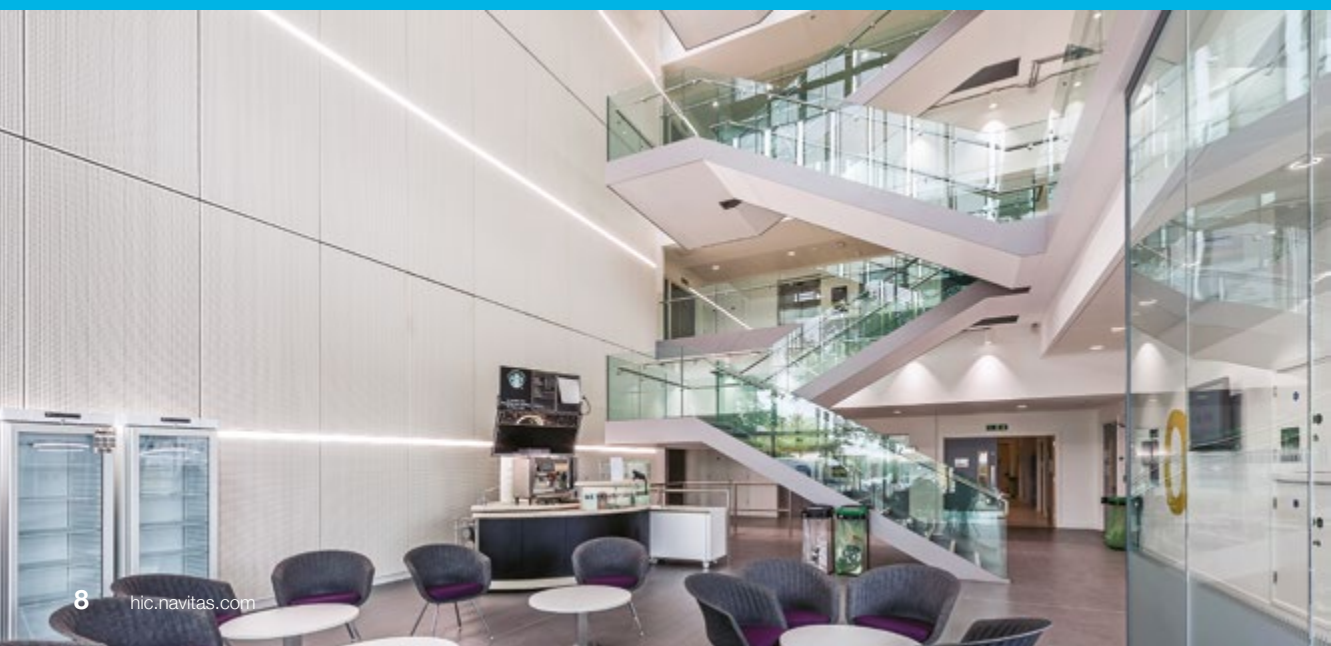

SAFE, ON-CAMPUS ACCOMMODATION

For lots of people, one of the most exciting things about coming to university is the chance to get a place of their own. At Hertfordshire, we can offer accommodation on College Lane campus. It's really convenient and a great way to meet new friends.

ON-CAMPUS ACCOMMODATION

There's been a lot happening on campus over the last few years.

An exciting £100m building project has transformed the campus, providing lots of high-quality new accommodation. In fact, the campus now has 2,500 brand new bedrooms, plus 500 refurbished ones, all close to lecture theatres, study centres and social spaces. They're sustainable, carbon-zero buildings and – with the final one opened in September 2016 – everything's looking shiny and new.

That includes The Oval, where you'll find a gym, common rooms, learning and social spaces, and a central hub with security and student services. We have two room types available on campus, the Standard En-suite with a single bed, and the Enhanced En-suite with a small double bed.

CONTRACT

Students can move in up to one week before the start of teaching and must vacate the property by the end of the contract.

CONDITIONS

A deposit of £1,000 is required to reserve your room with the remaining rental fees payable by two instalments. All of our accommodation comes with a bedding pack as standard and fortnightly kitchen cleaning.

	Standard En-suite	Enhanced En-suite
Individual fees		
Rent (per semester)	£2,862	£3,122
Caution fee (refundable)	£250	£250
Administration fee	£400	£400
Total contract fees		
One semester contract	£3,512	£3,772
Three semester contract	£9,236	£10,016

TWO SEMESTER CONTRACT (SEPTEMBER-JUNE)

	Standard En-suite	Enhanced En-suite
Individual fees		
Rent (per semester)	£7,138	£7,788
Caution fee (refundable)	£250	£250
Administration fee	£400	£400
Total contract fees		
Two semester contract	£7,788	£8,438

For the latest fees, please check our website:
hic.navitas.com/accommodation

PLEASE NOTE:

Accommodation contracts will be assigned according to course length and projected HIC pathway. IEL A students will be given 30% off their first semester's rent.

ACADEMIC CALENDAR

	Foundation/ Pre-Master's	Degree/ Master's	IEL A	IEL B	IEL C	IEL D
May 2020 (2002)						
Orientation starts	20 May	N/A	1 July	20 May	20 May	20 May
Classes start	28 May	N/A	8 July	28 May	28 May	28 May
Classes end	9 August	N/A	16 August	16 August	2 August	16 August
Exams	12 August	N/A	19 August	19 August	5 August	19 August

September 20120 (2003)						
Orientation starts	16 September	16 September	28 October	16 September	10 September	16 September
Classes start	23 September	23 September	4 November	23 September	24 September	23 September
Classes end	6 December	20 December	13 December	13 December	1 December	13 December
Christmas break	17 December– 7 January	23 December– 10 January	22 December– 20 January	22 December– 20 January	8 December– 20 January	22 December– 20 January
Exams	9 December	13 January	16 December	16 December	2 December	16 December

January 2021 (2101)						
Orientation starts	20 January	13 January	5 March	20 January	20 January	20 January
Classes start	27 January	27 January	9 March	27 January	27 January	27 January
Classes end	9 April	1 May	17 April	17 April	3 April	17 April
Easter break	10–13 April	10–13 April	10–13 April	10–13 April	10–13 April	10–13 April
Exams	14 April	4 May	20 April	20 April	6 April	20 April

May 2020 (2002)						
Orientation starts	18 May	N/A	2 July	18 May	18 May	28 May
Classes start	26 May	N/A	6 July	26 May	26 May	26 May
Classes end	7 August	N/A	14 August	14 August	31 July	14 August
Exams	10 August	N/A	17 August	17 August	3 August	17 August

September 2020 (2003)						
Orientation starts	14 January	14 September	29 October	14 September	14 September	14 September
Classes start	21 September	21 September	2 November	21 September	21 September	21 September
Classes end	4 December	18 December	11 December	11 December	27 November	11 December
Christmas break	20 December– 8 January	21 December– 3 January	19 December– 21 January	19 December– 21 January	6 December– 21 January	19 December– 21 January
Exams	7 December	N/A	14 December	14 December	30 November	14 December

Education for your world

Navitas provides you with the education you need, to get where you want to be in life. From English language skills and courses to help you enter university, to training for the workplace, Navitas colleges and campuses in 28 countries will support you every step of the way.

With over 120 Navitas and SAE Institution locations across the globe, and over 70,000 students currently studying with us, we understand the world's learning needs. We've become one of the most trusted providers of education and training in the world.

Navitas offers to students, professionals and migrants from around the world, the following opportunities:

- English language training
- High school studies
- University preparation and programmes
- Post-secondary education for creative media technology
- Career advancement programmes
- Student recruitment
- Internship programmes
- Migrant settlement services

We also offer customised workplace training for companies, and a range of training and settlement services for the Australian Government. Wherever you are, and wherever you want to be, the knowledge and resources of our staff around the world will ensure your success.



**36
UNIVERSITY
PARTNERS**



**OVER 120
INSTITUTIONS
WORLDWIDE**



**OVER
70,000
STUDENTS**

Africa

- SAE Institute, South Africa

Asia

- ACBT — Edith Cowan University, Sri Lanka
- Curtin Singapore (The Singapore Campus of Curtin University)
- SAE Institutions — Indonesia, Malaysia, Thailand

Australia

- ACAP (Australian College of Applied Psychology)
- CELUSA (Centre for English Language in the University of South Australia)
- Curtin College — Curtin University, Perth
- Deakin College — Deakin University, Melbourne
- ECC — Edith Cowan University, Perth
- Eynesbury College — The University of Adelaide and University of South Australia
- Griffith College — Griffith University, Brisbane, Gold Coast
- Hawthorn-Melbourne
- JCU College — James Cook University, Townsville, Cairns
- La Trobe College Australia — La Trobe University
- La Trobe University Sydney Campus
- Navitas English
- Navitas Health Skills Australia (HSA)
- Navitas Professional
- NIC — The University of Newcastle
- SAE Institutions — Adelaide, Brisbane, Byron Bay, Melbourne, Perth, Sydney
- SAIBT — University of South Australia, Adelaide
- SIBT, Sydney
- Western Sydney University Sydney City Campus
- Western Sydney University International College
- UC College - University of Canberra

Canada

- FIC — Simon Fraser University, Vancouver
- ICM — the University of Manitoba, Winnipeg

Central America

- SAE Institute, Mexico

Europe

- SAE Institutions — Austria, Belgium, France, Germany, Greece, Italy, Netherlands, Romania, Serbia, Slovenia, Spain, Sweden, Switzerland, Turkey
- Twente Pathway College, University of Twente, Netherlands
- The Hague Pathway College, The Hague University of Applied Science, Netherlands
- Lancaster University, Leipzig Germany

Middle East

- SAE Institutions — Jordan, Saudi Arabia, UAE
- Murdoch University Dubai

New Zealand

- SAE Institute, Auckland
- UC International College — University of Canterbury, Christchurch

United Kingdom

- BCUIIC — Birmingham City University
- CRIC — Anglia Ruskin University, Cambridge
- HIC — University of Hertfordshire, Hatfield
- ICP — University of Portsmouth
- ICRGU — Robert Gordon University, Aberdeen
- LBIC — Brunel University London
- SAE Institutions — Glasgow, Liverpool, London, Oxford
- The College, Swansea University
- UNIC - The University of Northampton
- University of Leicester Global Study Centre, University of Leicester
- UPIC — University of Plymouth

United States of America

- Florida Atlantic University Global Student Success Program
- Richard Bland College of William & Mary Global Student Success Program
- SAE Institutions — Atlanta, Chicago, Los Angeles, Miami, Nashville, New York, San Francisco
- University of Idaho Global Student Success Program
- University of Massachusetts Boston International Student Success Program
- University of Massachusetts Dartmouth Global Student Program
- University of Massachusetts Lowell Global Student Success Program
- University of New Hampshire Global Student Success Program
- Virginia Commonwealth University Global Student Success Program

HIBT Ltd trading as HIC
University of Hertfordshire
College Lane, Hatfield
Herts AL10 9AB United Kingdom

t. +44 (0)1707 285590
e. info@hic.navitas.com
w. hic.navitas.com
navitas.com



weibo.com/hicstudents/profile



[@hicstudents](https://twitter.com/hicstudents)



facebook.com/hicstudents



[@hic_students](https://instagram.com/hic_students)

Company Number 05163612; Registered in England and Wales.

The information contained in this guide is correct at the time of publication; however, HIC reserves the right to alter, amend or delete details at any time without notice.

This guide is provided free of charge.

HIC200327-0629



HIC is part of the Navitas Group.